

## Stainless Steel-Star knobs

Stainless Steel AISI 304 (A2)

### SPECIFICATION

**Version with female thread:**

#### Types

- Type **E**: with threaded blind bore
- Type **C**: with plain blind bore H7

Stainless Steel AISI 304 (A2)

Stainless Steel AISI 316L (A4)

- Knob drawn from Stainless Steel sheet
- Hub welded
- matt shot-blasted

**Version with threaded bolt:**

Stainless Steel AISI 304 (A2)

Stainless Steel AISI 316L (A4)

- Knob drawn from Stainless Steel sheet
- Hub with threaded bolt welded
- matt shot-blasted

### INFORMATION

The original ELESA design with 5 recess grips is typical for GN 5334 star knobs.

This form gives these grips an appealing look and additionally allows a high torque to be achieved.

### TECHNICAL INFORMATION

- Cross holes GN 110 (see page A17)
- ISO-Fundamental Tolerances (see page A21)
- Stainless Steel characteristics (see page A26)

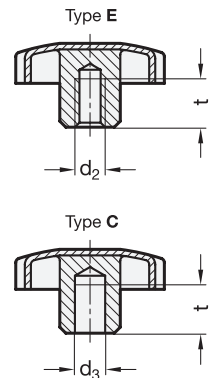
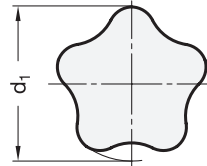
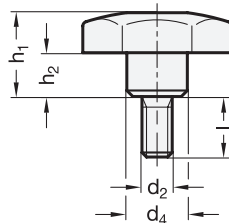

### GN 5334-with female thread

STAINLESS STEEL

Description	d1	d2	d3 H7	d4	h1 ≈	h2 ≈	t min.	⚖
GN 5334-40-B8-C	40	-	B 8	14	24	12	15	36
GN 5334-50-B10-C	50	-	B 10	18	30	16.5	18	67
GN 5334-60-B12-C	60	-	B 12	20	37.5	20	22	110
GN 5334-40-M8-E	40	M 8	-	14	24	12	15	38
GN 5334-50-M10-E	50	M 10	-	18	30	16.5	18	69
GN 5334-60-M12-E	60	M 12	-	20	37.5	20	22	112

### GN 5334.4-with female thread

STAINLESS STEEL

Description	d1	d2	d3 H7	d4	h1 ≈	h2 ≈	t min.	⚖
GN 5334.4-40-B8-C	40	-	B 8	14	24	12	15	37
GN 5334.4-50-B10-C	50	-	B 10	18	30	16.5	18	67
GN 5334.4-60-B12-C	60	-	B 12	20	37.5	20	22	109
GN 5334.4-40-M8-E	40	M 8	-	14	24	12	15	37
GN 5334.4-50-M10-E	50	M 10	-	18	30	16.5	18	68
GN 5334.4-60-M12-E	60	M 12	-	20	37.5	20	22	114

### GN 5334-with threaded bolt

STAINLESS STEEL

Description	d1	d2	l	d4	h1 ≈	h2 ≈	⚖
GN 5334-40-M8-20	40	M 8	20	14	24	12	50
GN 5334-40-M8-30	40	M 8	30	14	24	12	53
GN 5334-40-M8-40	40	M 8	40	14	24	12	57
GN 5334-50-M10-20	50	M 10	20	18	30	16.5	91
GN 5334-50-M10-30	50	M 10	30	18	30	16.5	96
GN 5334-50-M10-40	50	M 10	40	18	30	16.5	101
GN 5334-60-M12-20	60	M 12	20	20	37.5	20	155
GN 5334-60-M12-30	60	M 12	30	20	37.5	20	155
GN 5334-60-M12-40	60	M 12	40	20	37.5	20	161
GN 5334-60-M12-50	60	M 12	50	20	37.5	20	170

### GN 5334.4-with threaded bolt

STAINLESS STEEL

Description	d1	d2	l	d4	h1 ≈	h2 ≈	⚖
GN 5334.4-40-M8-20	40	M 8	20	14	24	12	43
GN 5334.4-40-M8-30	40	M 8	30	14	24	12	53
GN 5334.4-40-M8-40	40	M 8	40	14	24	12	57
GN 5334.4-50-M10-20	50	M 10	20	18	30	16.5	91
GN 5334.4-50-M10-30	50	M 10	30	18	30	16.5	97
GN 5334.4-50-M10-40	50	M 10	40	18	30	16.5	110
GN 5334.4-60-M12-20	60	M 12	20	20	37.5	20	155
GN 5334.4-60-M12-30	60	M 12	30	20	37.5	20	155
GN 5334.4-60-M12-40	60	M 12	40	20	37.5	20	161
GN 5334.4-60-M12-50	60	M 12	50	20	37.5	20	170

